

EXISTING OFFICE

TOTAL RSF 173,263 rsf

EXISTING MEZZANINE

TOTAL RSF 20,448 rsf

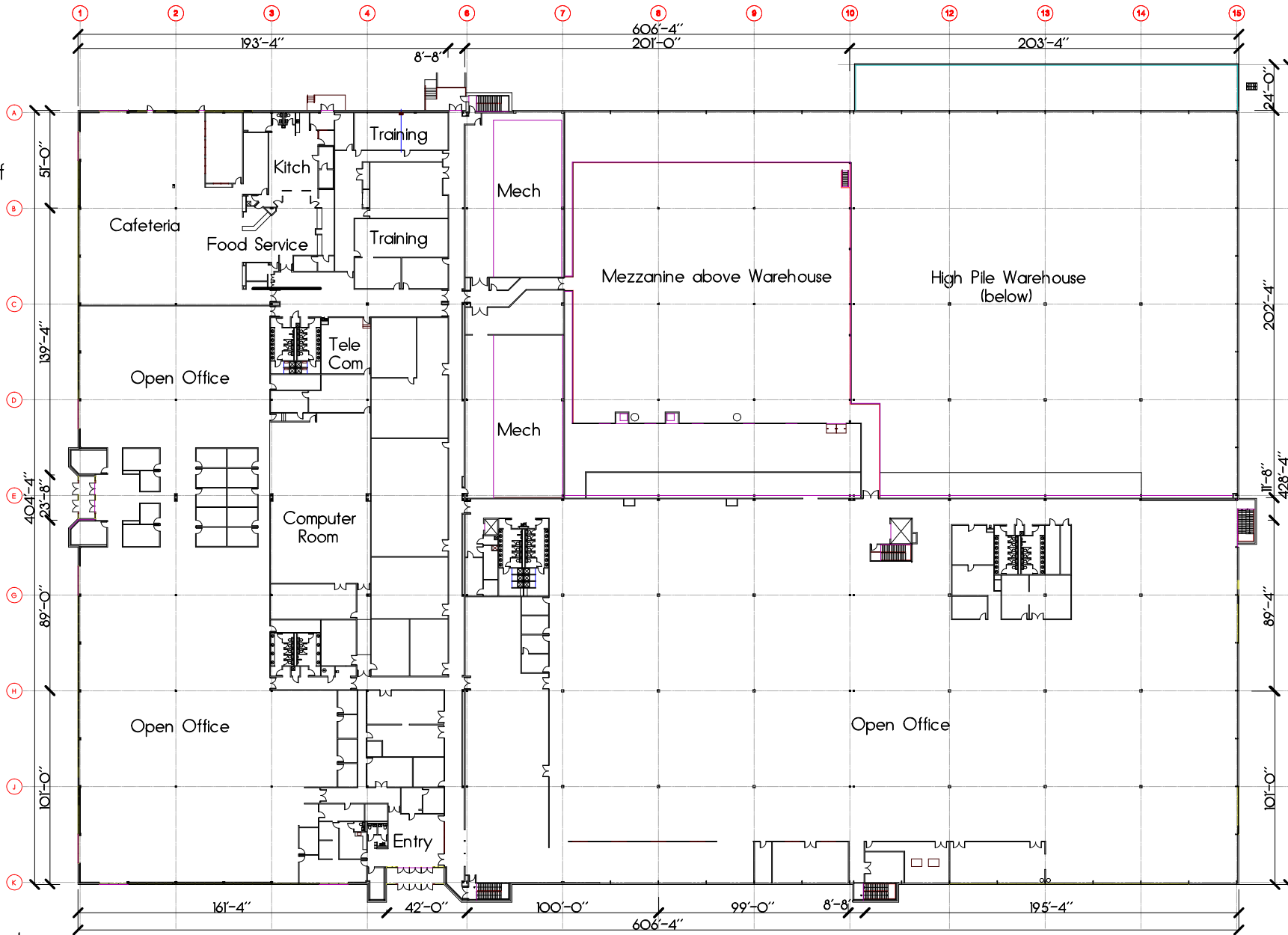

YOW Architects, PC



Contact:
 Michael Palmer
 719-228-3626 direct
 719-332-0044 cell

Fountain Business Park - Main Floor - Existing Plan

10 September, 2014

Scale: 1" = 75'0" - print on 8 1/2 x 11

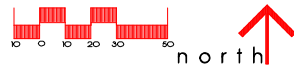

WAREHOUSE AREAS

North Warehouse
 High Pile 47,839 usf
 Building Mech 11,800 usf
 Non-High Pile 27,667 usf

Total North Warehouse
 87,306 usf

Total South Warehouse
 82,454 usf

Total Warehouse
 169,760 usf

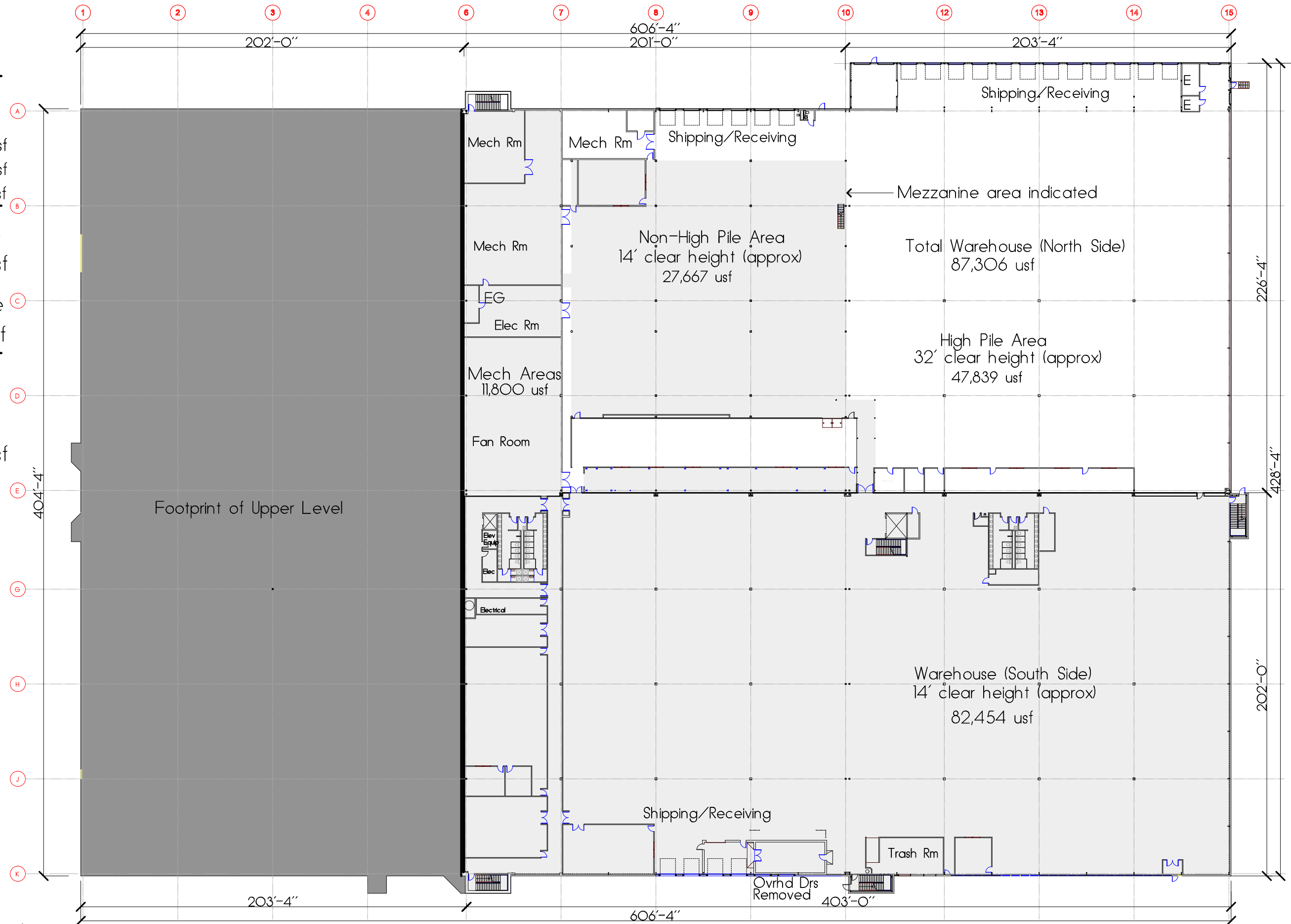

YOW Architects, PC



Contact:
 Michael Palmer
 719-228-3626 direct
 719-332-0044 cell

Fountain Business Park - Warehouse Level - Existing

10 September, 2014

Scale: 1" = 75'0" - print on 8 1/2 x 11

